

Portable Electric Tooth Punch – Q8

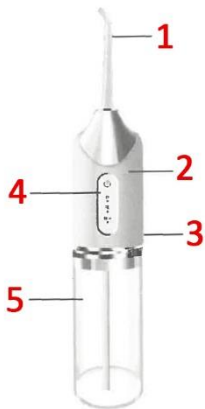

Instructions Manual

Punch structure



1. Nozzle; 2. Hold the handle; 3. Charging interface; 4. Control panel; 5. Water tank

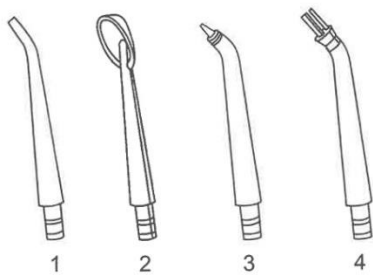

1. Standard nozzles are suitable for daily cleaning

2. The tongue coating scraping nozzle is special for cleaning the tongue coating

3. Periodontal bag nozzle special for periodontal bag cleaning
4. Orthodontic nozzle is suitable for hoop cleaning

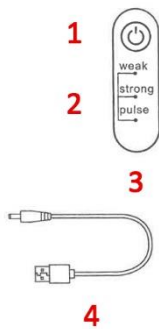

- 1.- Start / Stop gear adjustment.
- 2.- Gear indicator
- 3.- Control panel
4. Charging cable

Product specifications

Product model: Q8/Q9

Net weight: 225g

Water tank volume: 220ml

Charging voltage: 5V

Charging current: 1A

Rated voltage: 3.7V

Rated power: 3.5W

Operation Method

Short press the on key to start the machine. The default mode is weak and the corresponding indicator light is on. Long press the second switch mode, the mode is switched to the strong gear, at the same time, the indicator light is also switched to the opposite seat indicator, long press the second switch mode to the pulse gear, at the same time, the indicator light is also switched to the corresponding indicator light, cycle the short press on key to shut down. When the instrument works for 2 minutes, it will shut down automatically. When the battery is charged, the three indicator lights will flash in turn. When the battery is full, the three indicator lights will be on for a long time.

Use Steps

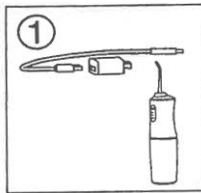

Please fully charge the device before using it for the first time

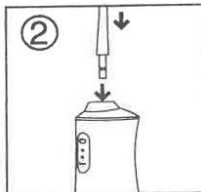

Insert the corresponding nozzle into the handle to ensure it is firmer and avoid water leakage during use

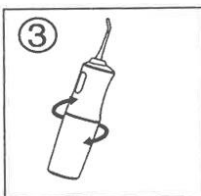

Rotate the water tank off the fuselage, remove the water tank

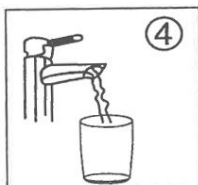

In the water tank to add water or water according to their own use

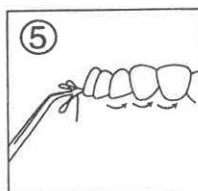

Put the nozzle in the middle of the day and align it with the position to be washed

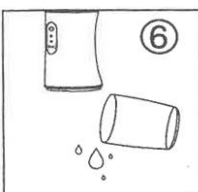

After use, open and remove residual water.

Correct method of cleaning teeth

Choose a suitable gear. It is recommended to try it from the lowest gear. When the hammer gradually finds the most suitable gear, put the nozzle into the mouth, aim at the crevice between the teeth or gums, and slightly open the mouth emblem, so that the water can flow out smoothly. After choosing the right gear, aim at the gum and wash it in the same direction (such as 1 or 4) from the innermost picture until it reaches the gum of the last tooth. Then turn the nozzle to aim at the gum and continue to wash it in the same direction (such as 2 or 3) until it reaches the gum of the last tooth. The washing sequence of the other row of teeth is the same as above.



- A. Strong pulse water can clean up bacteria, dental stains, tartar and food residues in all parts of the mouth.
- B. Superfine water flow can clean gingival groove and deep crevices barrier free, and improve gingival health.
- C. It can effectively remove most of the stubborn dental plaque on the surface of teeth, and the effect is much better than that of traditional dental floss.
- D. Fast clean mouth: whether at home or eating out, it is the most effective way to quickly restore clean mouth.
- E. For orthodontic teeth, implant teeth, tooth veneer cleaning has a good effect.
- F. Help to develop a healthy habit of daily interdental cleaning, so that the teeth always keep fresh and clean.

Warm tips for product use

Dental experts suggest that: the grate should be used in gentle mode for one week at a time, and then it can be used by pressing the switch button in normal machine mode after it is applied. The following points should be paid attention to when using:

- (a) the water flow direction is perpendicular to the teeth or gums;
- (b) move slowly along the teeth to clean the teeth in order
- (c)The nozzle is aligned vertically
- (d)Thoroughly clean teeth, brackets, crowns and dentures.

Do not spray water directly along the periodontal pocket for a long time for the first time to avoid gum discomfort.

✓Correct demonstration



X Wrong demonstration



Teeth punching tips

Put the nozzle into the mouth before turning on the switch, so that the water will not splash everywhere. In use, the gear gradually increases from weak to strong, and it is an adaptive stage to find the suitable gear that you can bear.

- A. If you need to clean the product, please wipe it with water or wet cloth, and then use dry cloth or other dry paper towel to remove the water stains left on the surface.
- B. Do not immerse the product in water.
- C. Do not clean the product with hot water over 50 degrees Fahrenheit.
- D. Do not bend, stretch or twist the nozzle water pipe
- E. It is recommended to replace the nozzle every 3 months.
- F. If you don't use this product for a long time, please empty the water in the water tank and place it in a cool and dry place

DANGER

- A. Please read this manual carefully before use to avoid injury or damage caused by improper operation.
- B. Do not disassemble the product without permission to avoid product damage or electric shock.
- C. Do not use water above 40 °C to flush teeth in the water tank to avoid scalding.
- D. If the product accidentally falls into the water during charging, please pull out the power plug first, then take out the product and wait for the water stains to completely dry before charging.
- E. If the power cord or plug is damaged, replace the power adapter before use.
- F. Avoid placing the product at high temperature. Do not put the product into fire. The battery may explode.

Warning

- A. Don't use the product for other purposes except oral cleaning.
- B. Don't press the gum or teeth with the nozzle to avoid damaging the gum.
- C. Don't spill the product into the water to avoid product failure.
- D. Do not use the product in high temperature and humid environment.
- E. Do not use the power cord when it is damaged.

Be Careful

- A. Do not use this product without the installation of nozzle.
- B. Some functional mouthwashes may be corrosive. Please confirm the composition of mouthwashes before use. Do not use them indiscriminately.
- C. If children, old people or operators want to use this product, please make sure someone supervises and instructs the users.
- D. Please put it out of the reach of children and infants, and do not use it as a toy. E. Patients with periodontal disease or those who have had oral surgery in the past 2 months or suffered from oral problems, please consult the doctor before use.

Be Careful

- A. Do not use strong gear to continuously wash the damaged gums or bleeding teeth to prevent inflammation.
- B. Please adjust the scouring intensity of pulse water flow in real time according to your oral condition.

Be Careful

- A. Do not immerse the whole machine in water, which may cause product failure or complete damage.
- B. If you do not use the product for a long time, please ensure that the water tank is dry and dry, and then store it again to prevent bacteria water passing test before delivery. If there is a small amount of clean water, it is normal

Fault Diagnosis

Unable to work or power on

Newly purchased or not used for more than three months

Please charge for more than 4 hours

The water pressure is very low at work

There is something blocked in the nozzle or the nozzle is deformed

Change the nozzle

It can only be used for a short time after charging

The battery has not reached its end of life

Insufficient charging time

Please contact customer service

Please charge for more than 4 hours

When charging, the charging indicator does not light up or jumps disorderly

The power supply is not connected properly

Adapter (charging head) mismatch

Product circuit is faulty Please connect the power correctly

Replace the adapter or plug directly into the USB socket

Please contact customer service

Do not spray water when working

New machine or idle for a period of time unused

1. Pull out the nozzle to flush the nozzle hole on the main body.
2. Suck hard against the nozzle

Disposal of rechargeable battery

When discarding the recycled products, please do not throw them in the same place as the general domestic waste, but hand them to the designated recycling center. Protecting the environment

1. The product can be used for lithium-ion battery, which contains some things that may affect the environment: when you lose this strict product, please don't let Jiang Ji write about his ordinary life and put it in the garbage; The
2. of Jiang's battery is decomposing this product: before the lithium battery is upturned *, it is necessary to shut the power supply or cut it off.
3. Take out the step of the lithium battery, pry and produce the clip of the crystal cover; Open the upper rose that produces crystal; Then take out the lithium battery.
4. The removed lithium batteries should be safely disposed and put into the battery recycling center designated by the government, which is conducive to environmental protection.

Special tips:

Only remove the battery when discarding the product, and before removing it again, please make sure that the battery is exhausted, and non professionals do not remove it