



Install APK



Install the Bluetooth Notification (more than 4.3)

Scan the QR Code built in the smartwatch through the QRScan function of QQ or Android Market to download and install the Fundo wear and Baidu voice. After successful installation, the UI is shown as the figure:



iOS Install APP (iphone 4S above)

Install the Bluetooth Notification

By App Store , 8.1.2 system supports two-dimensional code scanning. Search Fundo wear, Download and install this APP. After successful installation, the UI is shown as the figure: 

3. Find the smartwatch name and match with it. After successful match, the Bluetooth icon on the status bar of the smartwatch will display as green. The Bluetooth menu interface will display that a Bluetooth device is successfully connected.

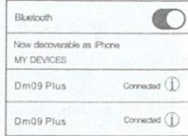

4. Click 'Search the Bluetooth' and find the smartwatch name and match with it. After successful match, this menu interface will display that two Bluetooth devices are successfully connected.

5. The Bluetooth icon on the status bar of the smartwatch will be displayed as gradient. Now the smartwatch and the phone can be searched with each other.

The Built-in Function on the watch

1. Pedometer: Click into the Option menu on the Pedometer, set personal details, wear the watch and click Start. Swing your arms regularly while walking, and the pedometer will count the steps and calculate the calories burned based on the total step counts.



2. Sedentary Reminder: Click into the Sedentary Reminder menu, and set the sedentary reminder time period after which it will ring and vibrate to alarm you to stand up and walk, as shown in the figure:

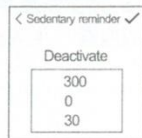

3. Sleep Monitoring: Go to the Sleep Monitoring menu, click Start and wear the watch. The user's sleep quality will be monitored based on the vibration degree and sleep time elapsed.

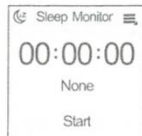

Bluetooth connection

1. Turn on the Bluetooth switch on the watch.
2. Turn on the Bluetooth switch on the phone, and click the "Fundo wear" to search and add the Bluetooth device.

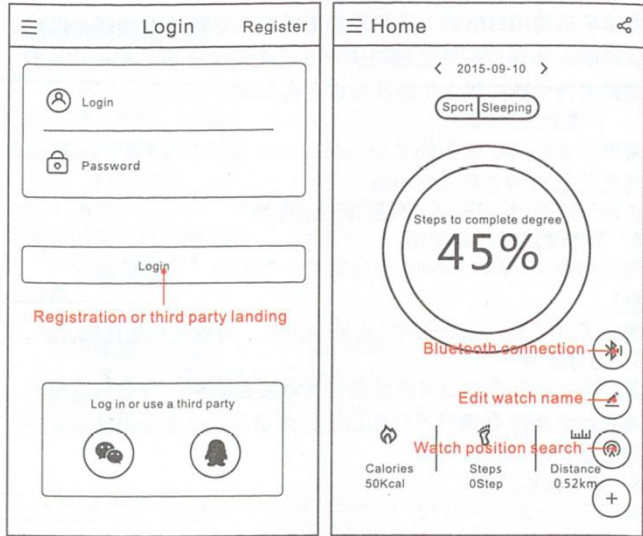

4. Knob function

Dial interface rotary knob to switch between different styles of dial;



In smart style interface, rotate knob, UI icon will zoom in and out.



In functional menu, short press knob into next.

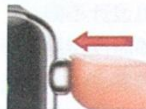

5. Support mobile phone SIM card (card) calls and SMS function, support for mobile phones, China Unicom card

6. Support watch camera function

Synchronization

Time Synchronization

If the Synchronous Switch on the watch is turned on by default (Settings – Clock – Time Synchronization), then after successful connection with the Bluetooth on the phone, the time and date on the watch will successfully synchronize with the current time and date on the phone and update accordingly.

SMS

1. If the Reminder on the phone is turned on (Generally in the Settings menu, depending on the different design of the phone with different platform), when the phone receives SMS, the status bar on the phone will display the reminder relating to the SMS and now the watch will also receive the reminder. All the information (except the facial sign) will display normally by clicking View.

2. Click into the SMS menu on the watch to preview all the information in the inbox. You can select any SMS to view, and make quick reply and call to the sender after viewing.

Dialing

Dial on the watch or the phone, then the watch will immediately synchronize with the phone.

Call

During the Bluetooth call, the interfaces of the watch and the phone will immediately synchronize with each other. While talking through the watch, you can adjust the volume, display the dial screen, mute and unmute, and end the call, etc.

Call Record

Click into the call log to view all the call records on the SIM card of your phone. Select and click any number to make Bluetooth call.

Contacts

Click into the phonebook to view all the contact number on the phone. Select and click any number to view and make Bluetooth call. (You can choose to synchronize with your phone for instant synchronization)

Bluetooth Music

Go to the Music menu and click Play to successfully play the music on your phone, thus controlling the music player. Click to reduce the volume, Click to increase the volume, Click to pause or Resume, Click to play the previous song, Click to play the next song.

Wechat

If the Wechat Message Reminder on the phone is turned on (Generally in the Settings menu, depending on the different design of the phone with different platform), when the phone receives Wechat messages, they will immediately be synchronized to the watch. You can view the content of these Wechat messages in the Notification menu on your watch.

Remote Camera (IOS does not support)

When the phone is unlocked, you can click Remote Camera on the watch to take pictures.

The Default Email Box, Twitter, Facebook, Skype, Outlook Mailbox, etc. on the system of the phone

If the Message Reminder on the phone is turned on (Generally in the Settings menu, depending on the different design of the phone with different platform), when there is a reminder on the status bar of the phone, there will also be a synchronous reminder on the watch. The corresponding interfaces will appear when making calls through Internet.

My Applications



After successfully connecting the watch and the phone, click My Applications in the Fundo wear menu to install the weather and the clock to the watch.

Common problem points out

In the use of mobile phones in the following common problems, can be resolved in accordance with the following

1, Synchronous SMS

SMS sync support Android phones, Apple phone does not support

2, Remote camera

After connecting the Bluetooth, the smart watch will pop up and Apple's camera interface directly, Androids can go directly to the camera, Apple will need to manually open the camera.

If Android Phones use other input method, it may affect the camera button. Please use the default input method in your phone. Remote Camera function is up to Android phone. The function can not work if volume "-" is not shortcut key for taking photos.

3, Watch can not boot

5 hours after complete power consumption, please charge the smart watch, 5 minutes later, press the power on/off button for 10 seconds to reactivate the battery.

4, Standby time of watch is very short

Battery is not fully charged. Please make sure it is fully charged. If connected with phone, the signal of location is poor, it will affect the use of watch.

5, Bluetooth Disconnect

Bluetooth signal is not good, it will automatically disconnect. And if alarm function is on, it will be repeatedly alarmed when disconnection.

6, There is no bluetooth authorization on smartphone. It can not trust the device. Bluetooth repeatedly disconnects and pairs. That is because the security of smartphone does not trust the smart watch. Please set it in setting-Security-trust bluetooth setting. (different phones have different setting.)

7, Voice quality is not good

Your smart watch is too far away from your phone. Your phone is in a bad blue signal, change the location of a call.

8, of the dynamic data can not be synchronized, because the background is not logged, the movement of data can not be stored in the backgroundStore, please register and log in;

9, Voice function



Apple voice features, for the use of the IPHONE machine Siri. Connect to Bluetooth, click on the menu icon, directly to wake up the voice of the machine, can operate voice dialing, etc.