

Heart rate monitor smartband



User Manual

About App

1. Dashboard: you can check the data of today, yesterday data and Data Summary (like sleeping data etc)



2. Realtime HR: check the heart rate data everytime tested

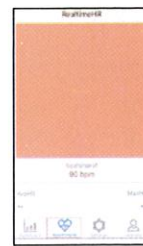

14

Bracelet take off instruction



This product uses the most advanced buckle hole Clasp design, please refer to the instructions as follows:



how to remove it off the wrist: Lift the bracelet tail, push forward the clasp gently (DON'T push it hard, incase the clasp pinch the arm accidentally)



Then move it backward from the hole, and remove the wristband from the circle

01

Smartband specification

Turn on the band: Told on touch the button for 4 seconds



02

Quick charging

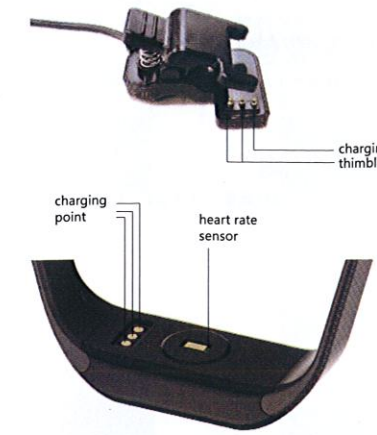

Put magnets into the charging point of the watch's caseba, quick charging is available.

03

Function Introduction

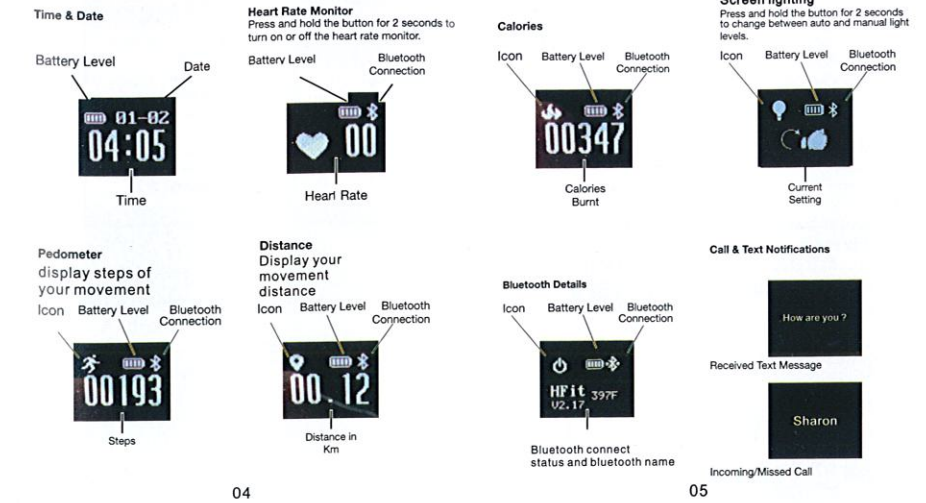

04

05

3. Stettings

(1) bluetooth: click to find out device bluetooth name to pair, please make sure your bluetooth is open of your smart phone.

(2) Sync: click to sync data from smart band (Remark: Android is Auto Sync)

(3) Alarm clock: for set alarm clock.

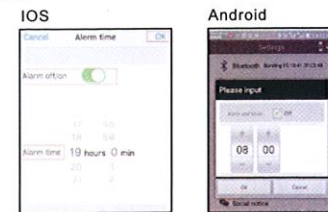

15

(4) Sit notification: for set notification time reminder when sit long time.

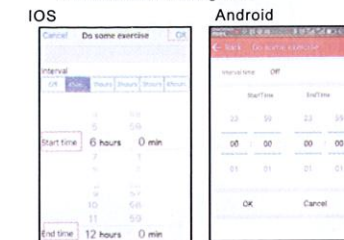

(5) Time Mode: set 24 hours mode or 12 hours mode

(6) Uite: set Metric or Imperial (android only)

(7) Device calls and messages notification (on settings of APP) For iOS Please turn on the "Incoming calls" on the APP for incoming calls reminder

IOS

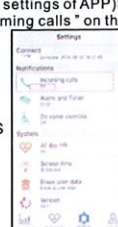

16

IOS messages reminder will remind you automatically For Android phone: please turn on "Incoming calls" on the APP for calls reminder, will display the Caller ID. Android messages notification click "Message" on the APP

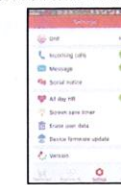

(8) Social notice: (Android) click "Social notice" (turn on the APP you want to notice) --- Stettings --- Notification access (turn on "Hplus Watch") --- OK

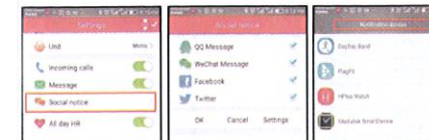

17

(9) All day HR: turn on will start to test heart rate every 10 minutes

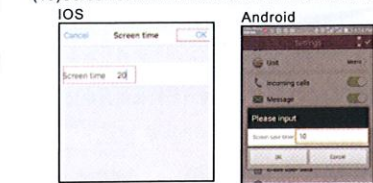

18

(11) Erase user data: Erase the data on the smart band



(12) Device firmware update: update firmware device

(13) Version: check the current version

User Info: set the information of the user.



19

Firstly need bluetooth pair

1. turn on the bluetooth of your mobile phone

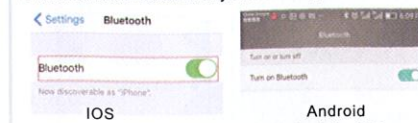

2. scan or log in the below link to download the APP (Hplus Watch) in your Android or IOS mobile phone.



Android
<http://fir.im/hplus>



Google Play
<http://play.google.com/store/apps/details?id=com.richtechie.hplus>

Apple Store
<http://itunes.apple.com/us/app/hpluswatch/id1021512165?l=zh&ls=1&mt=8>

06

Specification

Size : 230mm X 20 mm
Weight : 20g
Waterproof : IP67 (support take shower or swimming)
Battery : Li-battery
Capacity : 150mAh
charging : 5V
System : Android 4.3 and above, ios 7.0 and above.

The information above is only for reference, the company reserves the right to amend this manual without any prior notice. No replica is allowed without the company's permission.

20

IOS



Android



Android



3. open the APP, go to "Settings" menu click "Bluetooth" to find your device bluetooth name to pairing. (for the bluetooth name please turn to the device home screen to check, like 1B9F)



07

NOTE:

1. Time and date sync

After the device has been connected successfully with your phone, the time will auto synchronize correctly with your phone. If not, select "Sync" in App to allow synchronous data.



2. how to reset to factory-default:

please turn the wristband to the Turn-On/Off menu (as shown), long-press the button, and release it until it appears "Hplus" (Note: please remain long-press if it shows "goodbye-welcome-goodbye-Hplus", it is done only if it shows "Hplus")



Figure 1

3. how to turn on/off the All-Day Heart-Rate mode:

How to Turn on:
All-Day Heart-Rate can ONLY be turned on from cellphone APP, which bluetooth connecting with the wristband. All-Day Heart-Rate is power-saving mode, monitor the heart-rate every 10 mins., the green light will be on and monitor, the green light will off after monitoring.

21

How to Turn off:

All-Day Heart-Rate can ONLY be turned off from cellphone APP, which bluetooth connecting with the wristband. If the cellphone dis-connect with wristband or cellphone get lost, we NEED to reset to factory-default (see the instruction 1)

4. how to bluetooth connect to another wristband in one cellphone (or how one wristband change to connect with several mobile phone):

If one cellphone need to bluetooth connect to another wristband or one wristband need to bluetooth connect to another mobile phone (while it connected one before), please go to APP- System Settings - Bluetooth device, and do 3 steps as below:

- (1) un-binding the bluetooth connection with before wristband by slide the screen,
- (2) ignore or delete the bluetooth of before wristband from mobile phone settings-bluetooth
- (3) reset the before wristband to factory-default (see the instruction 1)

If only reset to factory-default but without un-binding, the wristband will continue switching to "Hplus" and main menu..

22

How to disconnect bluetooth

IOS:

1. on the APP ---settings ---click "Bluetooth" ---down pull the page

2. then turn to the settings of the SMART PHONE ---Bluetooth--- "Forget This Device"

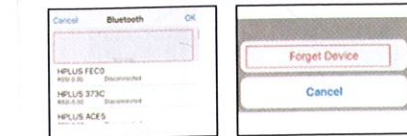

Android

1. on the APP ---settings ---click "Bluetooth" ---"Are you sure remove this device" ---OK

2. Turn to the settings of the SMART PHONE ---Bluetooth--- "unpair"

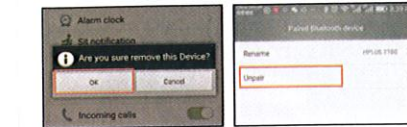

09

FAQ(change pairing to another smart phone)

QUESTION 1. Change to another phone smart band can not be connected
Answer: Because of the smartband with the mobile phone had binding data before, need to remove data connection

Remove data connection steps:

1. Please turn off Hplus Watch APP on the smart phone
2. smart phone ---setting---bluetooth---delete the H3 smart band bluetooth (which had connected before)
3. turn to the turn off display screen, long press touch button 10 seconds, until appear HPLUS. Now you can see the time is 8:20, means finished the remove data connection (process shows: turn off --turn on --turn off---Hplus)

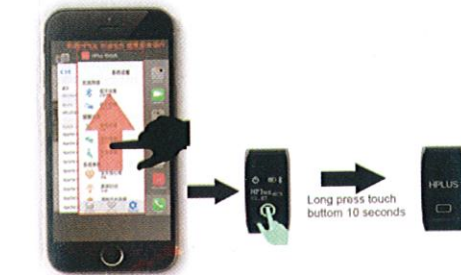

23

Data and time Synchronism

On the App-- settings --Sync--(before your check the data on the "Dashboard" please make sure Sync the data on settings of the APP) for Android phone Data Sync automatically

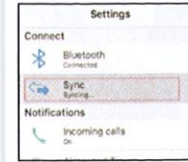

10

QUESTION2: smart band repeat turn on at the first bluetooth connect or second time bluetooth connection (after remove data connection)

Answer: smart phone first time connection or after remove data connection will still reminder to connect with smart band after disconnect. So if not paired, will repeat reminder to pair to the last smart phone which connected before

Steps to deal with this:

1. Please turn off Hplus Watch APP on the smart phone
2. smart phone- setting - bluetooth -delete the smart band bluetooth(which had connected before)
3. Reopen Hplus Watch APP connect bluetooth again.



24

Auto Screen lighting:

please kindly know from 0:00am to 6:00am. devices default to turn off automatic bright screen, avoid to disturb your good dream.

Better way wear smart band.

It will be better if your wear the smart band on your left hand, 1.5cm after styloid process of ulna, and please make sure the heart rate sensor close to your skin (means do not too loose)

Sleeping monitor

Device will automatically monitoring sleeping quality from 21:00pm ----9:00am

11

QUESTION3: connected but not reminder and display the messages

Answer: because smart band had binding data of the last smart phone

Steps to deal with this:

1. turn to the turn off display screen, long press touch button 10 seconds, until appear HPLUS. Now you can see the time is 8:20. means finished the remove data connection (process shows :turn off-- turn on-- - turn off----Hplus)
2. open Hplus Watch APP, connect bluetooth again. Android smart phone need to back to the Hplus Watch Settings - Social notice --- setting--- turn on Notification access



25

Realtime heart rate monitoring

Long press button B for 2 seconds to start/stop realtime heart rate monitoring at such interface.

This shows realtime heart rate monitor is on, heart rate data will display after 15 seconds. Wait until it starts.

Realtime heart rate data display



Long press button B for 2 seconds at heart rate display interface to start realtime heart rate monitoring, waving heart(♥) icon shows real-time heart rate monitoring is on. Pressing button B for 2 seconds again to stop monitoring.

12

QUESTION4: bluetooth connected but data not synchronism

Answer: when bluetooth connect with the smart phone, first time synchronism

Because of the unstable bluetooth or too far away between the smart phone and the smart band.

1. Please turn off Hplus Watch APP on the smart phone
2. smart phone- setting - bluetooth -delete the smart band bluetooth(which had connected before)
3. Reopen Hplus Watch APP connect bluetooth again.

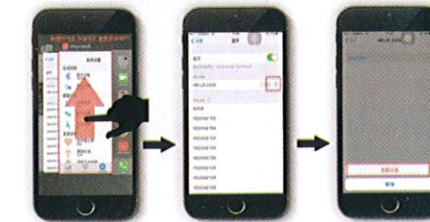

26

Realtime Heart Rate VS All-day Heart Rate

Realtime Heart Rate: Heart rate monitor will keep working when Realtime Heart Rate is started and green light could be seen through caseback. (Timely closing the Realtime Heart Rate function is suggested for low power-consumption)

On : Realtime heart rate interface

Off : Realtime heart rate interface

All-day Heart Rate: When All-day Heart Rate is started on APP, heart rate monitor will work every ten minutes and green light could be seen through the caseback. (All-day Realtime Heart Rate function consumes more power.)

On : All-day Heart Rate interface

Off : All-day Heart Rate interface

All day heart rate only can turn on on the App

13